

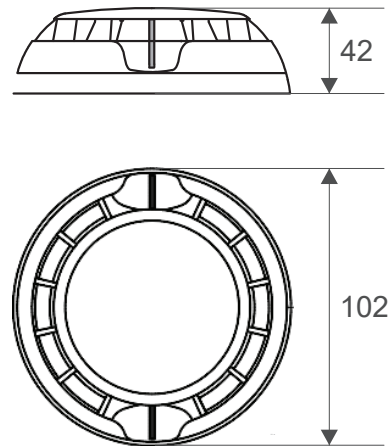

Dimension Details



Description

The S30 is an optical-smoke detector with digital processing algorithm. The detector is designed to detect smoke in the very early stage of the fire situation. The S30 is suitable for installing in any conventional fire alarm system designed with fire alarm panel with fire alarm threshold between 10mA and 15mA.

Technical & Environmental Specification

Operating Voltage Range	9 - 30 V DC (Nom. 12/24VDC)
Average current consumption in quiescent state	< 50µA
Alarm state current: <i>B24</i>	20 mA / 12-30V
Output in alarm state at terminal RI (<i>Towards terminals +IN /+OUT</i>)	20mA (max)/ -3.3V
Wire Gauge for terminals	0.4mm ² 2.0mm ²
Operational temperature range	-10°C +60°C
Relative humidity resistance	(93 ± 3)% @ 40°C
Dimensions (incl. base)	∅102mm, h 42mm
Weight (incl. base)	160g

Application

The S30 is a high sensitive optical smoke detector. It is suitable for applications where early detection of smoke or fire is with great importance, for example office buildings, supermarkets, schools, etc.

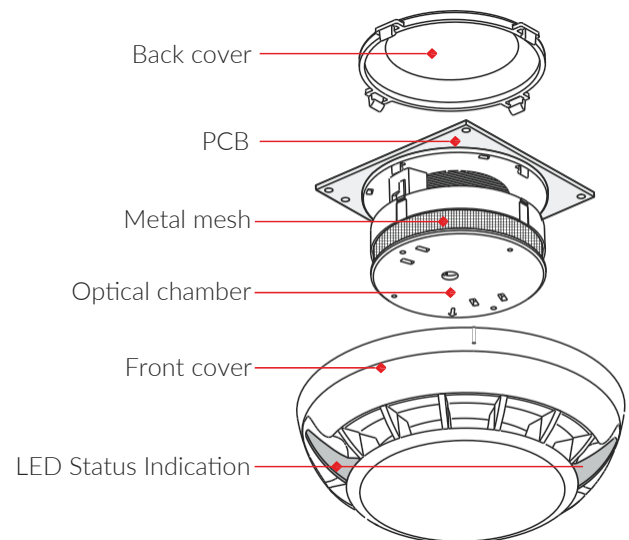

Packing Information

Master box

10 units S30, no bases included, dimensions 335 x 109 x 109 mm.

All detectors are protected with a plastic cap.

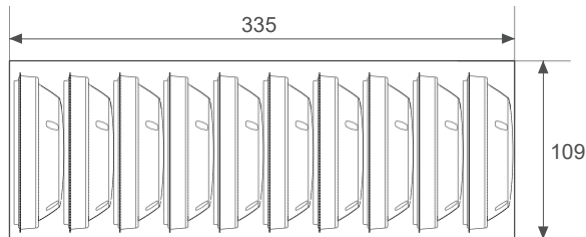

Carton box

100 units S30, (10 master boxes), no bases included, dimensions 556 x 345 x 231 mm.

All detectors are protected with a plastic cap.

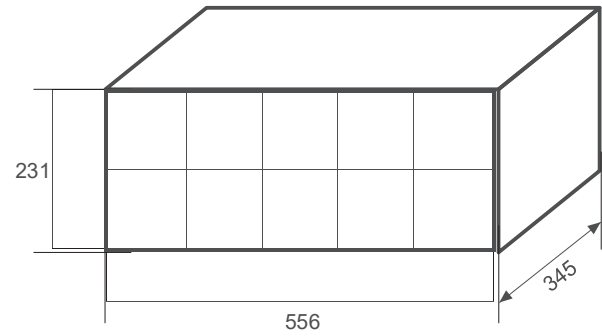

Compatible Product Range

- EAGLE 1 - Conventional Fire Alarm Panel, 1 fixed zones
- EAGLE 2 - Conventional Fire Alarm Panel, 2 fixed zones
- EAGLE 4 - Conventional Fire Alarm Panel, 4 fixed zones
- EAGLE 6 - Conventional Fire Alarm Panel, 6 fixed zones
- EAGLE 8 - Conventional Fire Alarm Panel, 8 fixed zones
- EAGLE 12 - Conventional Fire Alarm Panel, 12 fixed zones
- EAGLE 16 - Conventional Fire Alarm Panel, 16 fixed zones
- EAGLE B24 - Standard Base